



Mayor's Bicycle Advisory  
Commission 06.29.2022



## Agenda

1. Approve April minutes
2. Community Updates and Presentations
  - a. Recurring Community/City Events
  - b. Special Events / Other public announcements
3. Bike Master Plan Update – Team Introductions
4. City Updates
  - a. Mayor's Office
  - b. Planning
  - c. BPD
  - d. BCRP
  - e. DOT
    - Dockless Vehicle Update
    - Bike Program Overview
5. Miscellaneous Business
  - a. **Rescheduled: July meeting will be held**  
**August 3<sup>rd</sup>**



## Community Events

### Recurring Rides & Events:

#### MONDAY

- Crank Mavens WTF ride: NW Corner of Washington Monument, 7:00pm
- Magic Mondays: Druid Hill Basketball Courts 6:00pm

#### TUESDAY

- Taco Tuesday Ride: Washington Monument, 6:30pm
- Tuesday Lake to Lake, Lanise Stevenson: Druid Hill Basketball Courts, 6pm

#### WEDNESDAY

- Wheels Up Wednesday: Druid Hill Basketball Courts, 6pm
- BCRP Guided Rides: Alternating Druid Hill & Carroll Park 5-8pm

#### THURSDAY

- Black People Ride Bikes Conditioning Ride: Lake Montebello, 6pm
- Fly Wheelz Thursday Ride Out: Madison Avenue arches, 6:30pm
- BCRP Ride Around: Lake Montebello 5-8pm

#### FRIDAY

- Second Fridays- Next Ride July 8 - Baltimore Bike Collective Night Ride: 3559 Boston Street 8pm
- Last Fridays- Next Ride July 29 - Baltimore Bike Party: St Mary Park, 6:30pm

#### SATURDAY

- Saturday Morning Coffee Club Ride: 32<sup>nd</sup> Street Farmer's Market, 10am
- BCRP Ride Around: Lake Montebello 9am – 3pm
- Second Saturdays - Soul Food Saturday Ride: BPRB, Changing Routes
- Last Saturdays - Saturday Exploratory Ride: BPRB, changing routes





## Community Events

### Special Events:

Teach a Child to Ride Day!

Backyard Base Camp, BCRP, and Black People Ride Bikes

Saturday July 9, 9am- 12noon

Lake Montebello Loop, school playground

Bike Party - July Ride

Friday July 29, 6:30pm

St Mary's Park, 600 N Paca Street

Maryland Cycling Classic

September 1-4

Citywide events

Bike and Brunch Tours – Paid tours, \$25-\$40

Friday- Sunday dates through September

Visit [bikeandbrunchtour.com](http://bikeandbrunchtour.com) for more info



*Submit community events at*

<https://www.bikemore.net/submitevent>



# Baltimore City Bike Plan Update

**MBAC MEETING**

*JUNE 29, 2022*

# SCOPE

- Develop an updated Bicycle Master Plan
- Expand on the 2015 Bike Master Plan and 2017 Separate Bike Lane Network Plan
- Focus on:
  - Updating goals and objectives
  - Refining the future bicycle network plan
  - Calibrating recommended projects to funding sources
  - Integrating bicycle facility selection with the 2021 Complete Streets guide

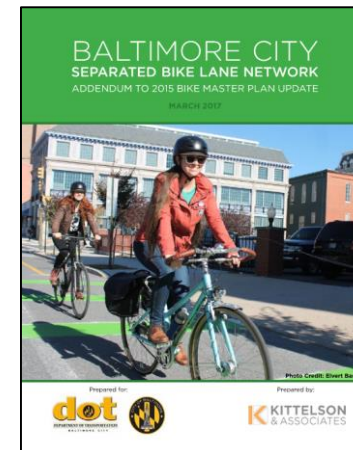

# MBAC ROLE

- Provide input on:
  - Goals and objectives
  - Recommended bicycle network
  - Plan implementation
- Specific opportunities for input
  - **MBAC Workshop 1** – Focus: *Updated goals/objectives and strategies/responsibilities for implementation*
  - **MBAC Workshop 2** – Focus: *Recommended bicycle network plan & project prioritization*
  - **Review of Draft Plan**
  - **Updates at MBAC meetings**

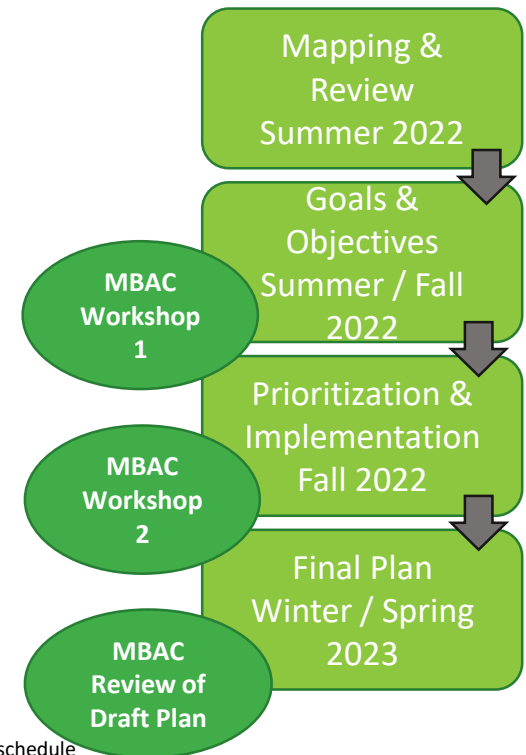

\*Anticipate a roughly 10-month project schedule

## Mayor's Office Updates

No new updates





## Updates: Planning

### City Planning: Zoning and Baltimore Greenway Trail Network

- Welcome Eli Pousson!
- Greenway Trail
- DOP Updates

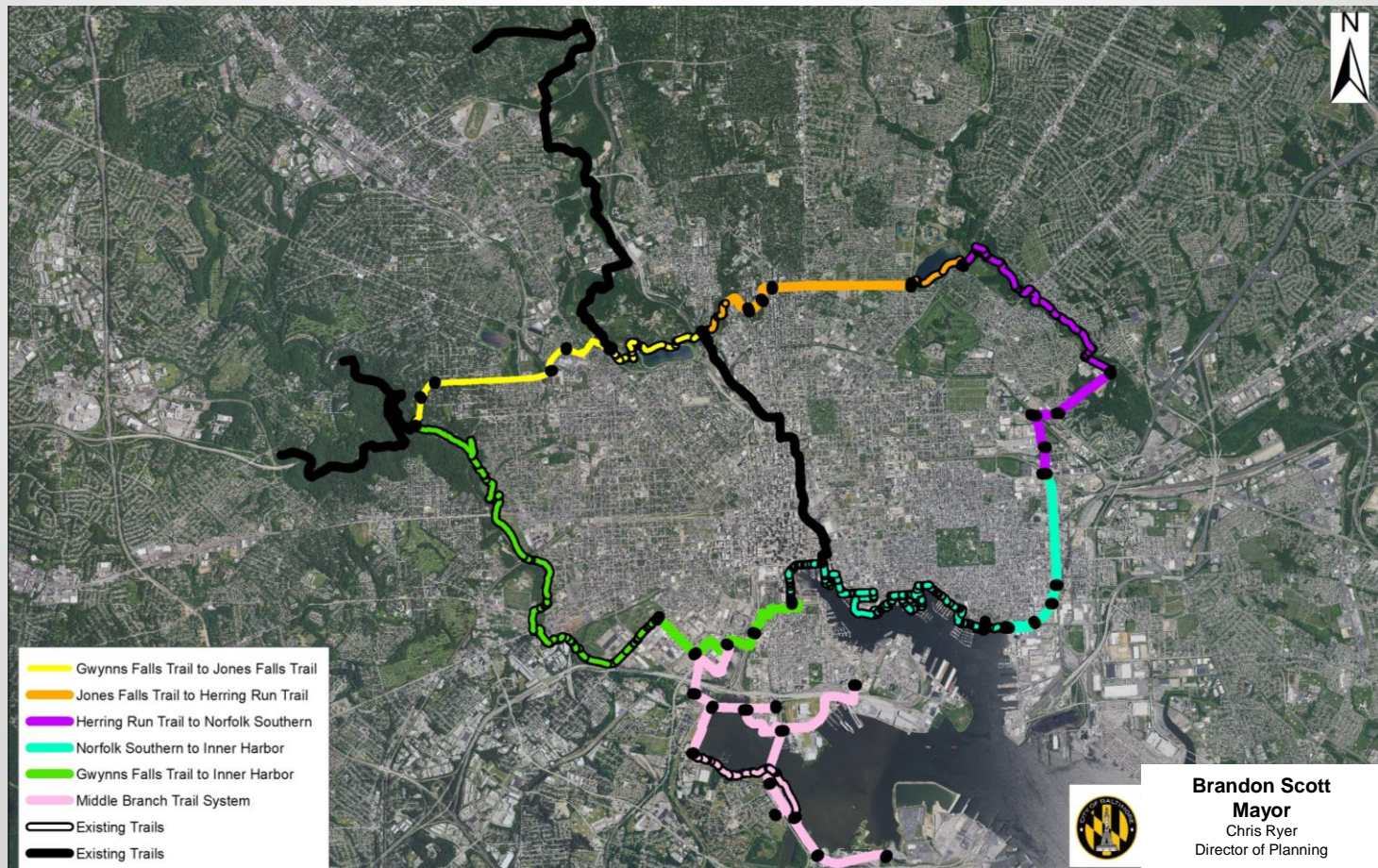



### Crash report information and updates.





## Updates: BPD

### Bike Larceny Tips

- Record serial numbers to enter into NCIC
- Ensure bikes are secured (including on vehicles)
- Keep a bike picture on phone to assist BPD

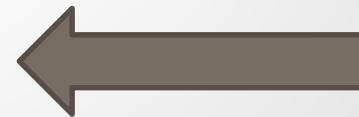

Stolen YT Capra Mountain Bike  
CC # 2206-08323  
Southern District on 6/26/22

## Updates: Rec & Parks

### Updates:

- 2022 Programs
- 2022 Part time staff application
- Pump Track
- Park Cleanups





## Updates: Rec & Parks

### 2022 Public Bike Program Schedule

- **Wednesdays May-Sept (5-8pm)**—alternating Druid Hill Park and Carroll Park. Druid Hill has been very slow without the Farmers Market. Carroll is doing well so far!
- **Thursdays May-Sept (5-8pm)**—Lake Montebello rides
- **Saturdays May-Oct (9am-3pm)**—Lake Montebello and Herring Run rides

### 2022 Rec Center & School Bike Program Schedule

- **Wednesdays–Fridays March-August** we will have 3 different Rec Center programs or Schools participate in biking programs on GFT, Jones Falls Trail, and Middle Branch Trail!

← Program QR Code

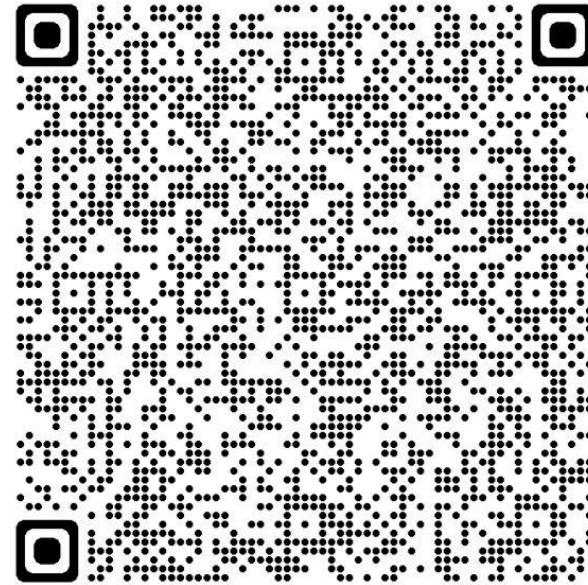

← PT Staff Application  
QR Code (\$15/hr)

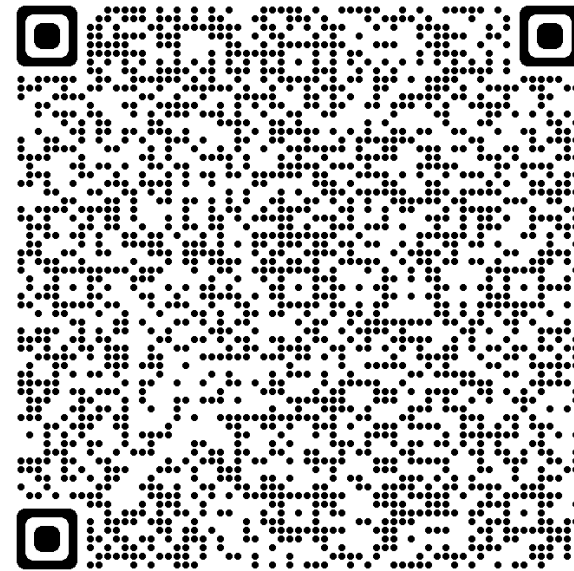



## Updates: Rec & Parks

### PUMP TRACK

- Pump track is setup at Carroll Park now until mid July to coincide with the new bike program and special events.
- Any requests in the community for the next location?





# Park Cleanups

-With the help from the Naturalist Trail Coordinators (Sam Little and Chris Golden) we have held 6 Park & Trail community cleanups with 1 more scheduled on July 21.

- Jones Falls Trail
- Gwynns Falls Trail (3)
- Herring Run (2)
- Chinquapin Run





## Micromobility Updates: Dockless

- Spin was awarded the first permit renewal as a result of permit compliance and community rankings. Spin will continue to serve Baltimore City with their e-scooters branded in dark orange and is exploring bringing e-bikes to the market.



## Micromobility Updates: Dockless

- Superpedestrian will continue to serve Baltimore City with e-scooters, seated e-scooters, and adaptive vehicles for people with disabilities. Their vehicles are branded with fluorescent yellow.





## Micromobility Updates: Dockless

- Bird will return to Baltimore City with their e-scooters and an expanded fleet of e-bikes. Bird vehicles are branded in silver and blue.



# Micromobility Updates: Dockless

There was a 72% increase in rides in 2021 compared to 2020

## Weekly Trips, Annual Comparison

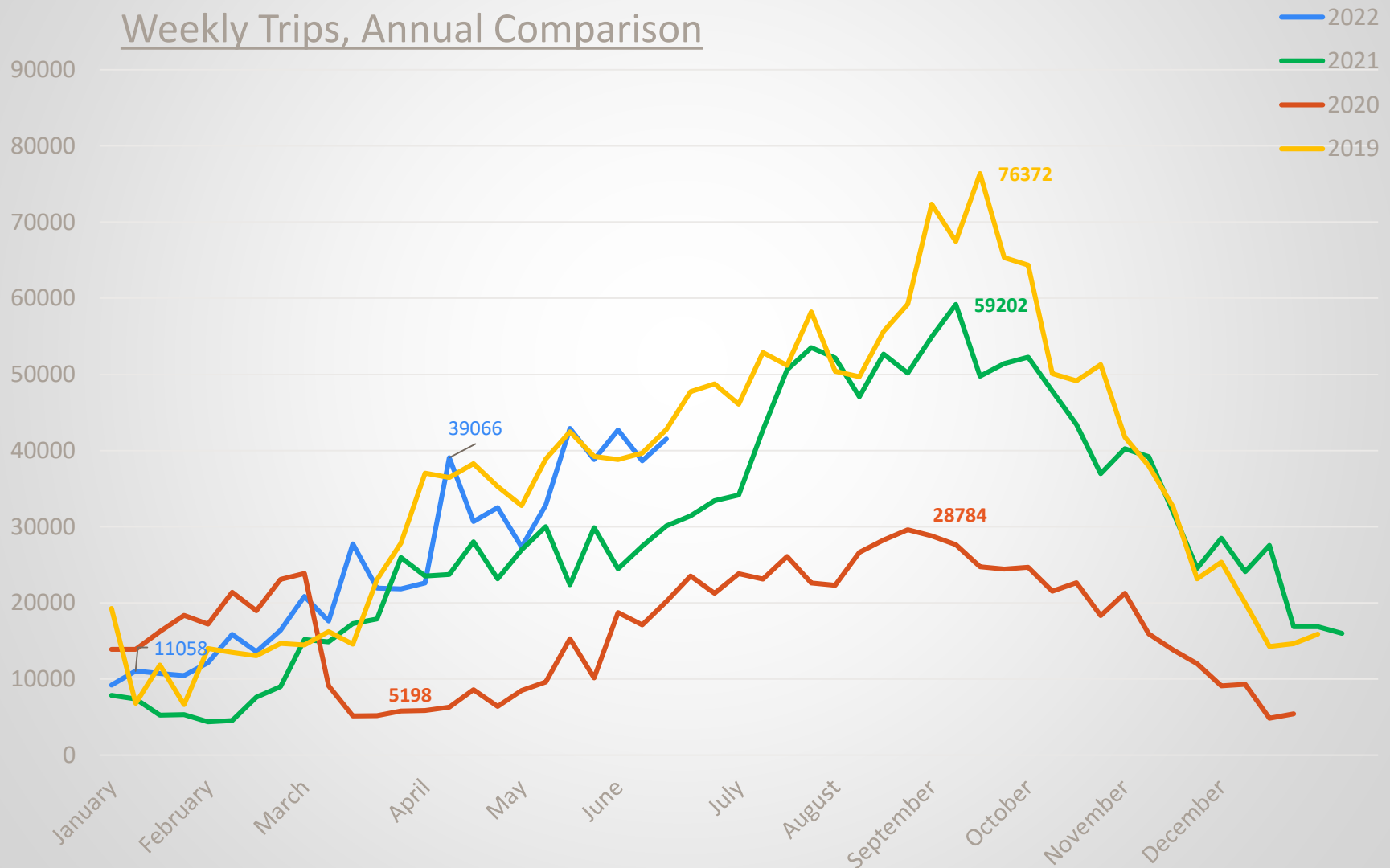



## Micromobility Updates

### Stay Up to Date

DVC Webpage is up to date:

- Next Meeting on July 13
- Subscribe to monthly mailers or submit data requests (example below) to [Dot-community@baltimorecity.gov](mailto:Dot-community@baltimorecity.gov)
- Visit: <https://transportation.baltimorecity.gov/dockless-vehicle-committee>

Monthly Ridership from Equity Zones



## Updates: DOT Bike Program & Projects

### Bike Program Updates:

- DOT is Hiring!
- Bike Counter Survey Update and Focus Group
- DOT Bike Projects and Construction
  - Review designs for Vision Zero and Quick Build Projects
  - Light, Monroe, Paca, Liberty Heights
  - Eutaw Place
  - University Parkway and St. Lo Drive





## Updates: DOT Bike Program & Projects

### Baltimore City Department of Transportation is hiring!

Positions available include office, maintenance,  
and labor positions.

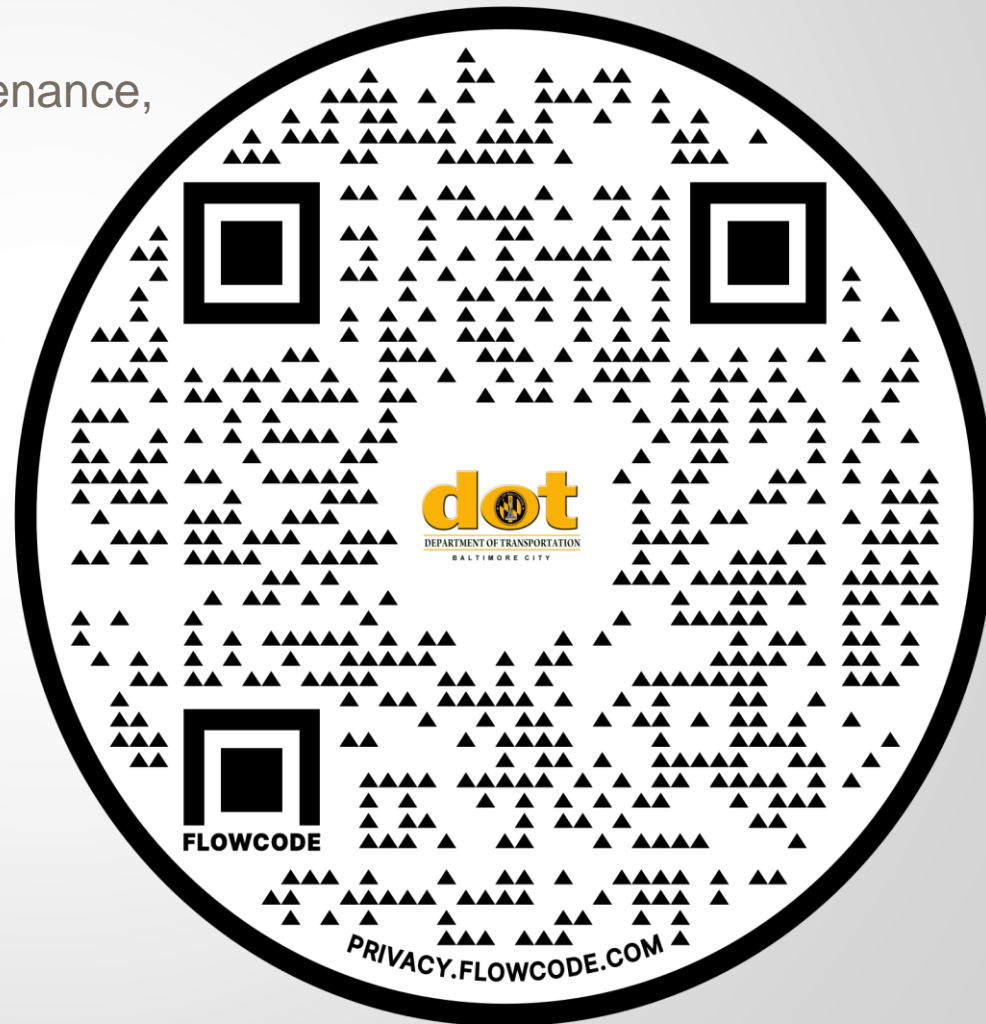

## Updates DOT – Automated Bike Counters

### Automatic Bike Counter Public Outreach Strategy Updated

- Revised Survey complete
  - Will be emailed by end of week
- 10 Person Focus Group
  - MBAC members are being contacted
  - Collect feedback about types of counters and installation locations prior to purchase

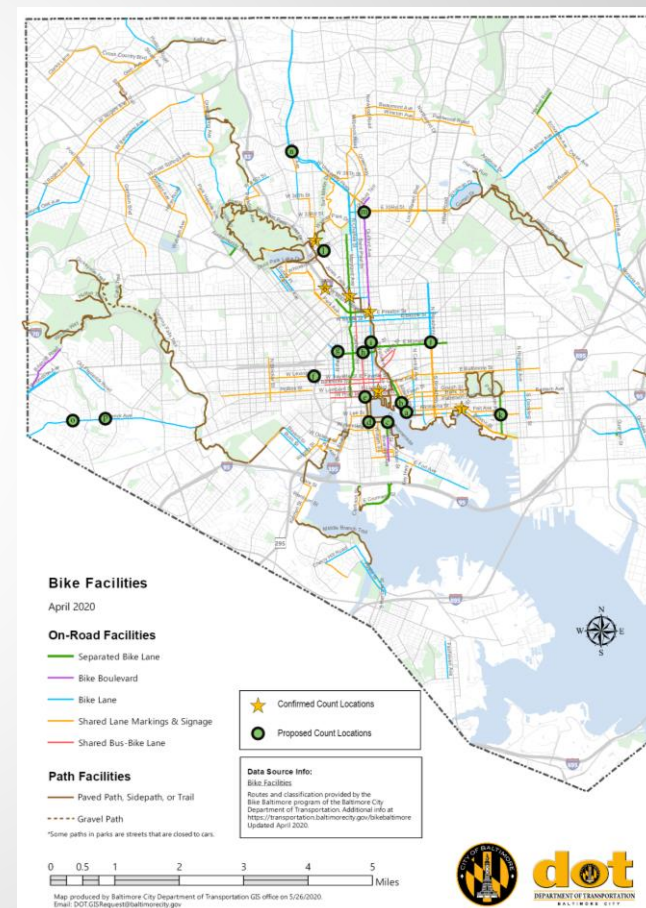

Contact [Patrick.Patterson@baltimorecity.gov](mailto:Patrick.Patterson@baltimorecity.gov) for questions or comments



## Updates DOT – Automated Bike Counters

### Metro Count Temporary Automatic Bike Counter Pilot

- Test data collection capabilities for Metro Count temporary counters.
- North of intersection of West Cathedral Street and West Center Street
- Data to be collected by end of week

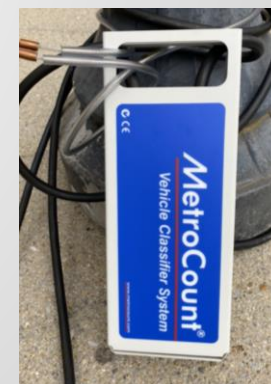

## Updates: DOT Bike Program & Projects

### Vision Zero Plans and Projects:

Shayna Rose, DOT Planner and Vision Zero PM

#### Projects Overview:

- Light
- Monroe
- Paca
- Liberty Heights

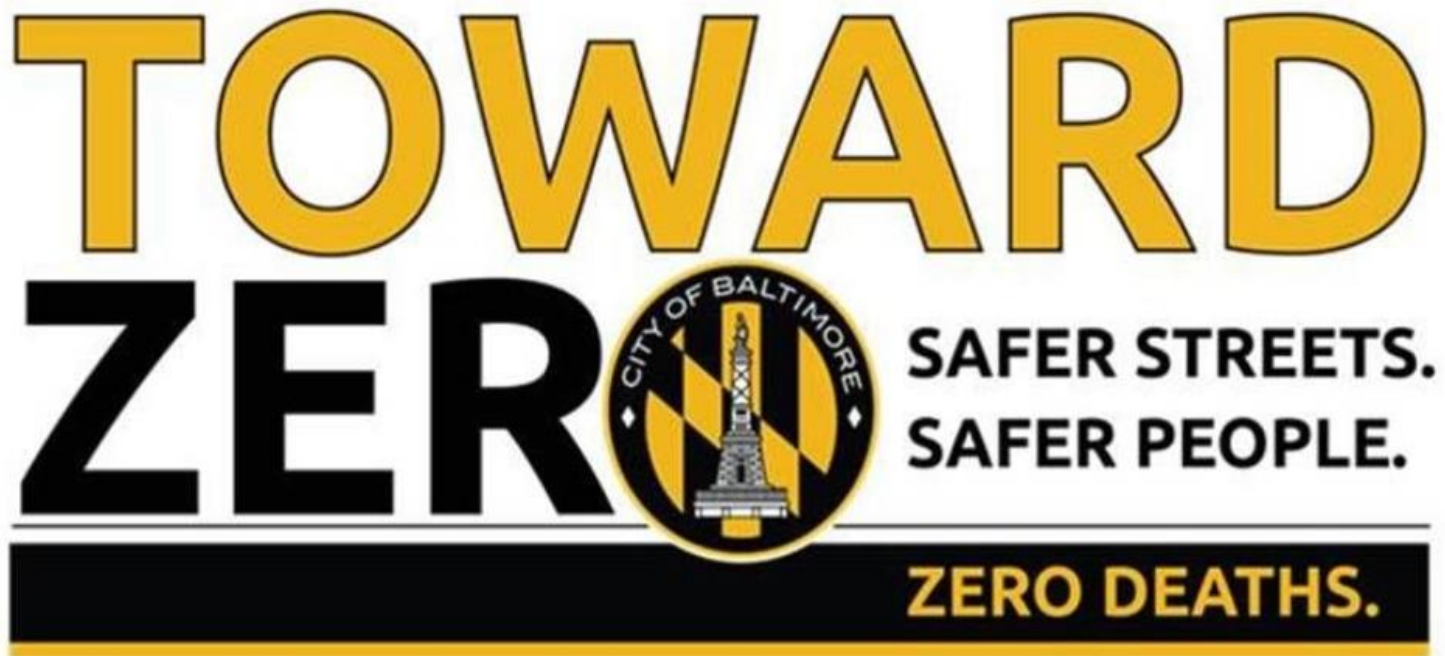



# Toward Zero “Quickbuild” Program



Brandon M. Scott  
Mayor



- As part of Baltimore City’s “Toward Zero” initiative, DOT identified four high-crash locations for rapid implementation projects
- These “Quickbuild” projects incorporate cheap and easy-to-implement infrastructure – i.e. striping, paint, flex posts, and signage – to improve infrastructure safety at intersections and along corridors
- Project designs adhere to Baltimore’s Complete Streets Manual, prioritizing the movement of pedestrians, cyclists, and transit riders
- **Construction planned in Fall of 2022**

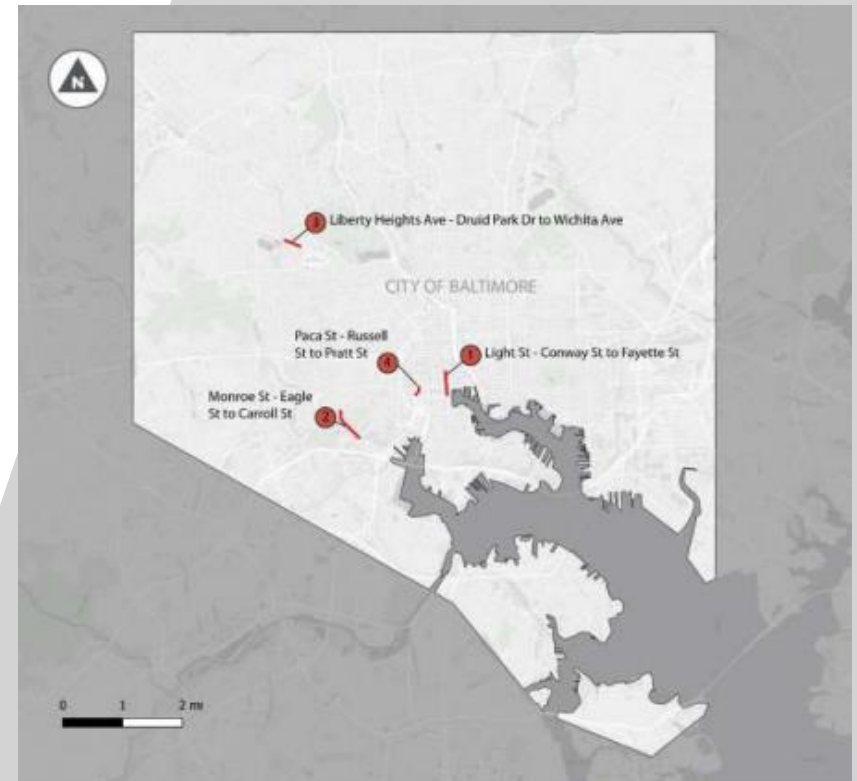

# Toward Zero “Quickbuild” Program

## Monroe Street – Eagle to Carroll



Brandon M. Scott  
Mayor



- Create two-way separated bike lane on Monroe Street between Washington Blvd and Eagle St. Add wide median. This will take Monroe Street down to one vehicle lane in each direction.
  - DOT is pursuing concrete planters in partnership with Montgomery Park to protect the two-way separated bike lane and extend the character of Carroll Park into the Right-Of-Way
- Adjust signal lengths of traffic lights on Monroe Street to have shorter cycles during off-peak hours. Coordinate traffic lights for slower speeds.



# Toward Zero “Quickbuild” Program Monroe Street – Eagle to Carroll



Brandon M. Scott  
Mayor

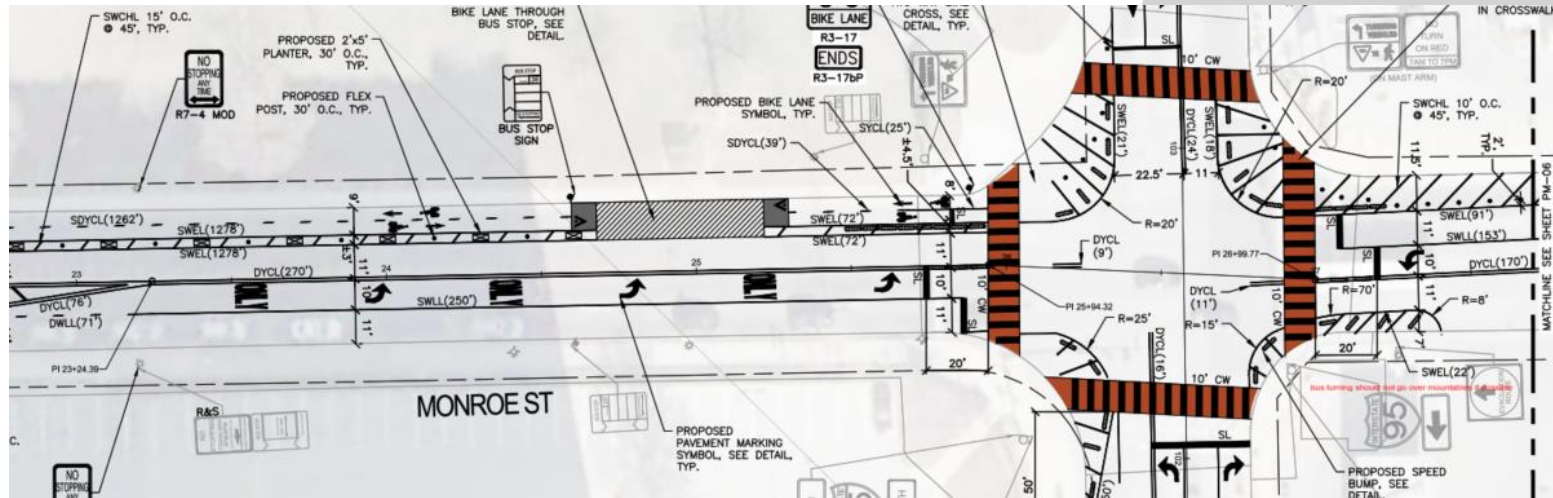

- Add curb extensions to reduce curb radii on all corners using paint, rubber speed bumps, and bollards
- Add textured pavers for all crosswalk legs
- Add hardened centerlines on all approaches using rubber speed bumps
- Provide dedicated left turn lanes
- Create right-only lane on the west leg of Washington Blvd with one through traffic lane and one left-only lane
- Take east leg of Washington Blvd to one vehicle lane

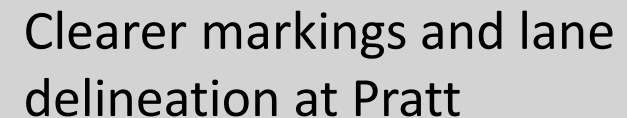





- [illegible]

- 
- dot**  
DEPARTMENT OF TRANSPORTATION  
BALTIMORE CITY



# Toward Zero “Quickbuild” Program Light Street – Baltimore to Conway



Brandon M. Scott  
Mayor



- Protected bike lane beginning at Baltimore, extending to Pratt
- Lane drop
- Heightened visibility at intersections for peds

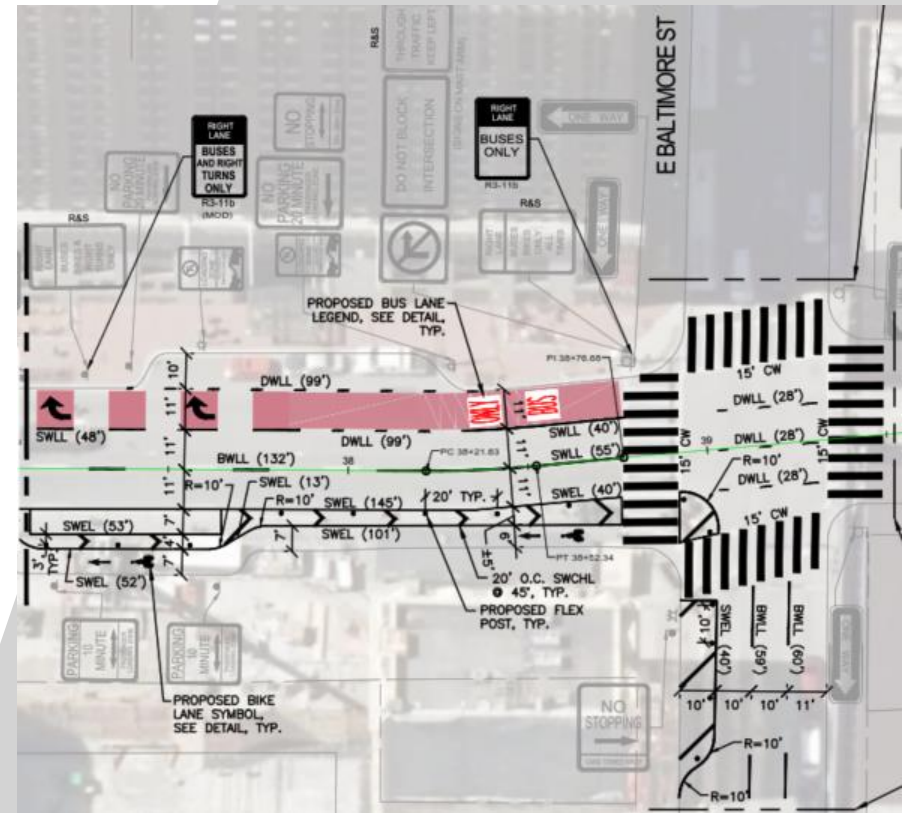

# Toward Zero “Quickbuild” Program Light Street – Baltimore to Conway



Brandon M. Scott  
Mayor

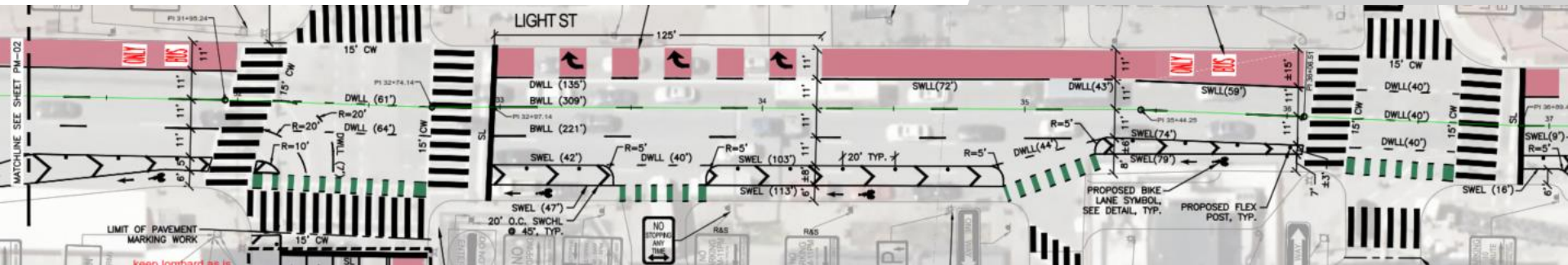

- Continuation of bike lane
- Transitions from two to three through lanes



# Toward Zero “Quickbuild” Program Light Street – Baltimore to Conway



Brandon M. Scott  
Mayor

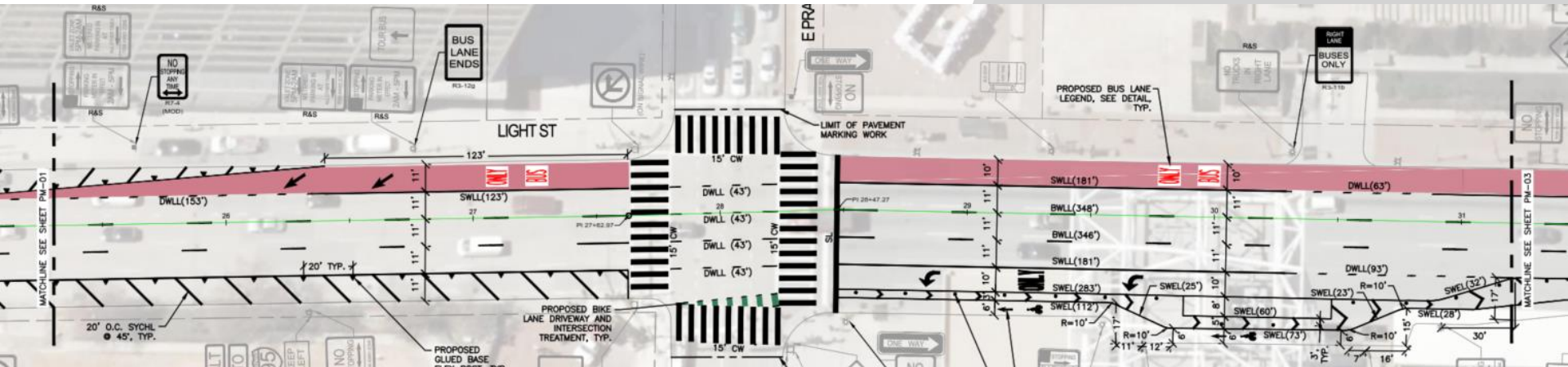

- Lane drop south of Pratt
- Bike lane ends
- Bus lane merges into traffic



**Brandon M. Scott**  
**Mayor**

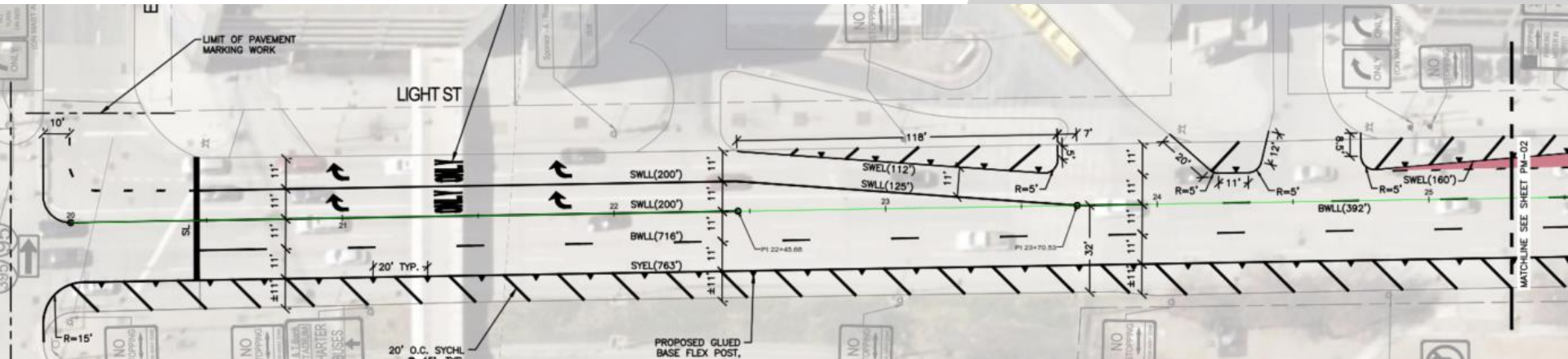

- Continue to use striping and flex posts to maintain two through lanes



## Updates: DOT Bike Program & Projects

### Bike Projects, Construction, and Complete Streets Improvements:

#### Projects/Plans Overview:

- Eutaw Place
- St. Lo
- University Parkway





## Eutaw Place - Design

### Project Overview:

- Review Eutaw Place Design Concepts
  - No final design plans presented
- Next Steps – Summer Meeting TBD





# Eutaw Place: Bike Lane Design

## Section 1: MLK to Druid Hill Ave./Centre

- Two-way bike lanes, parking reduction, and additional “bus islands”

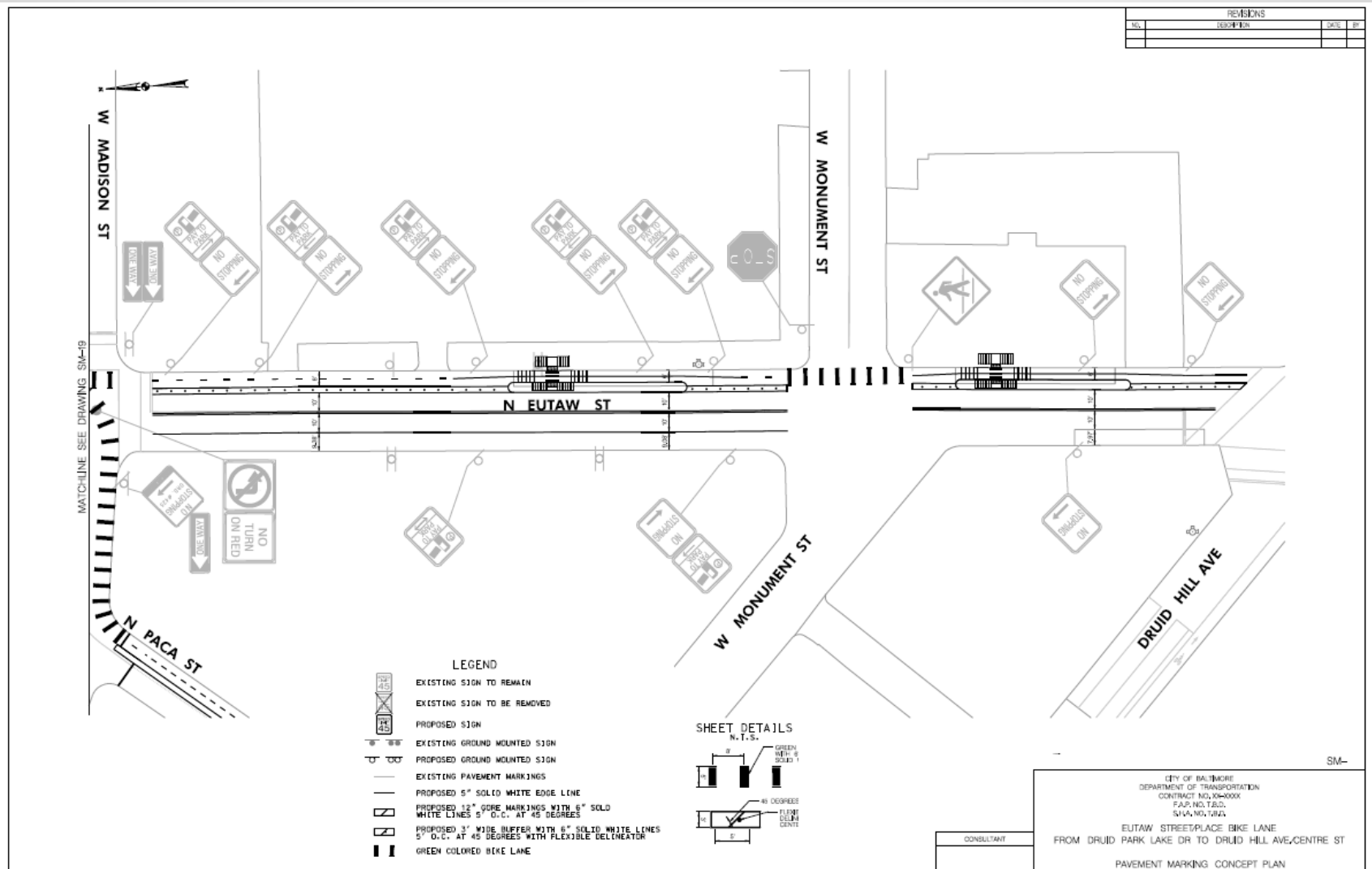

# Eutaw Place: Bike Lane Design

## Section 1: Dolphin to MLK

- Typical section – Needed adjustments

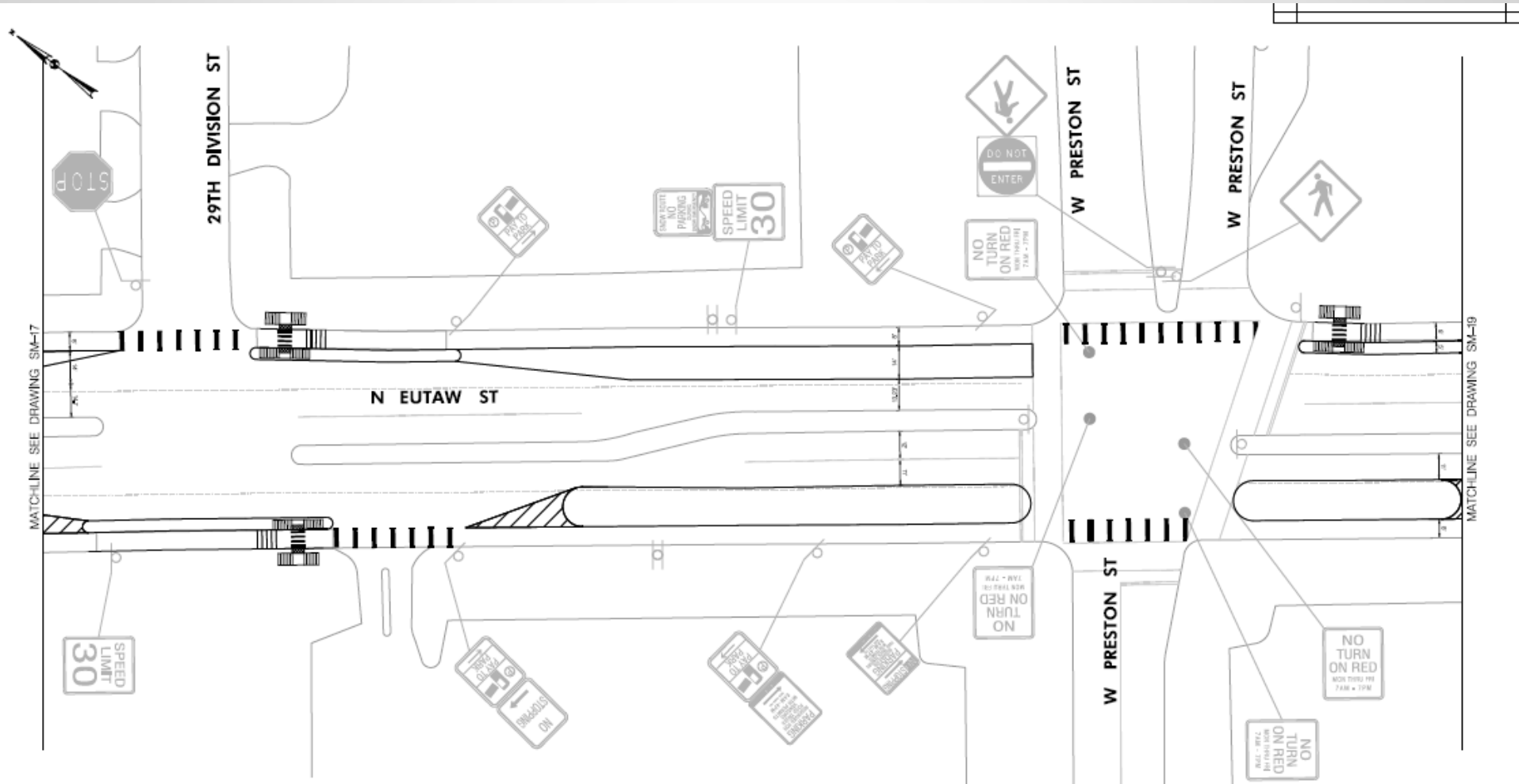

# Eutaw Place: Bike Lane Design

## Section 2: North Avenue to Dolphin

- Example typical Median alignment two one-way lanes

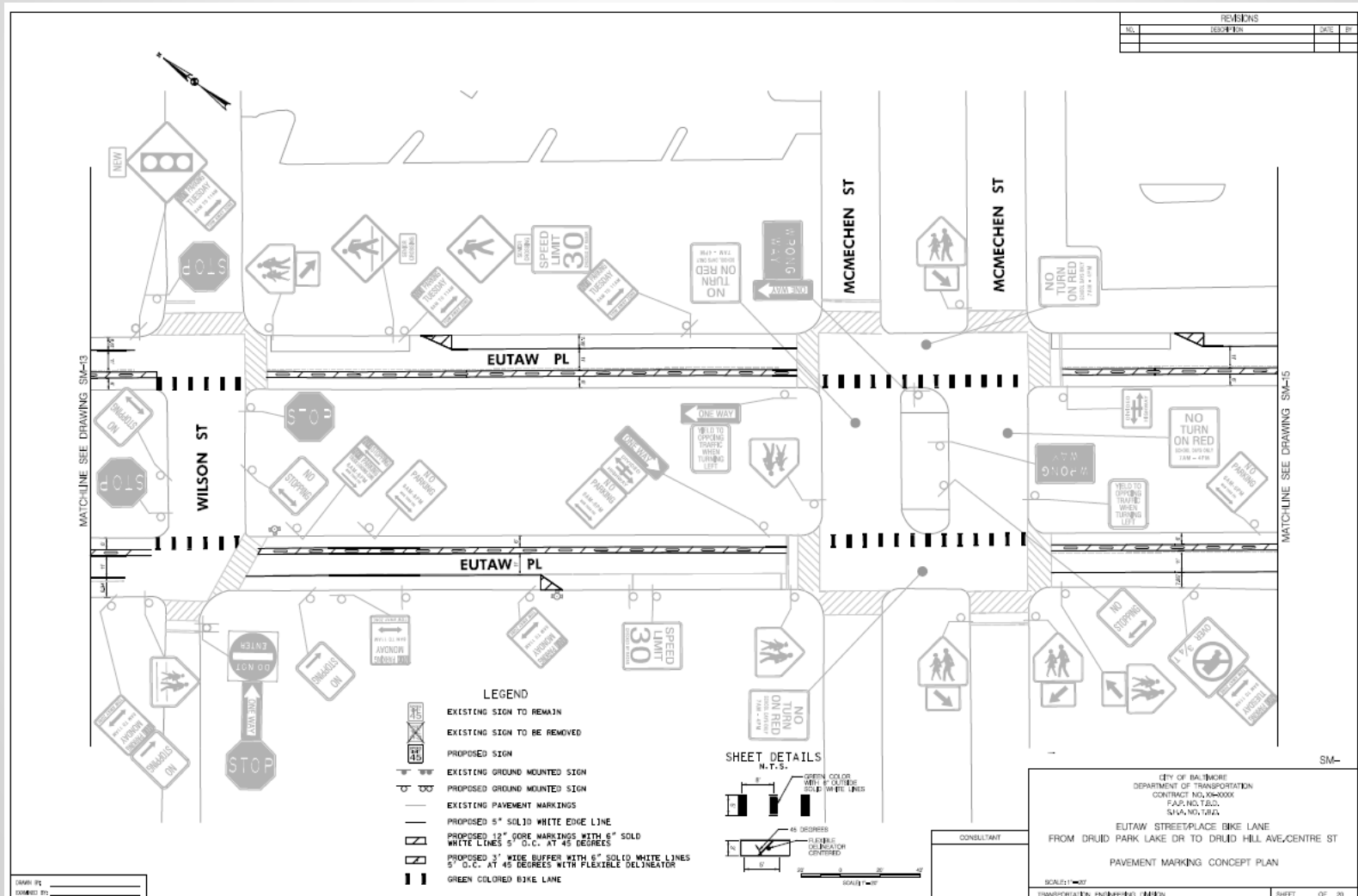



## Eutaw Place: Bike Lane Design

### Section 3: Druid Park Lake Drive to North Avenue

- Two, one-way pairs on Eutaw Place and Madison
- Typical Sections for design

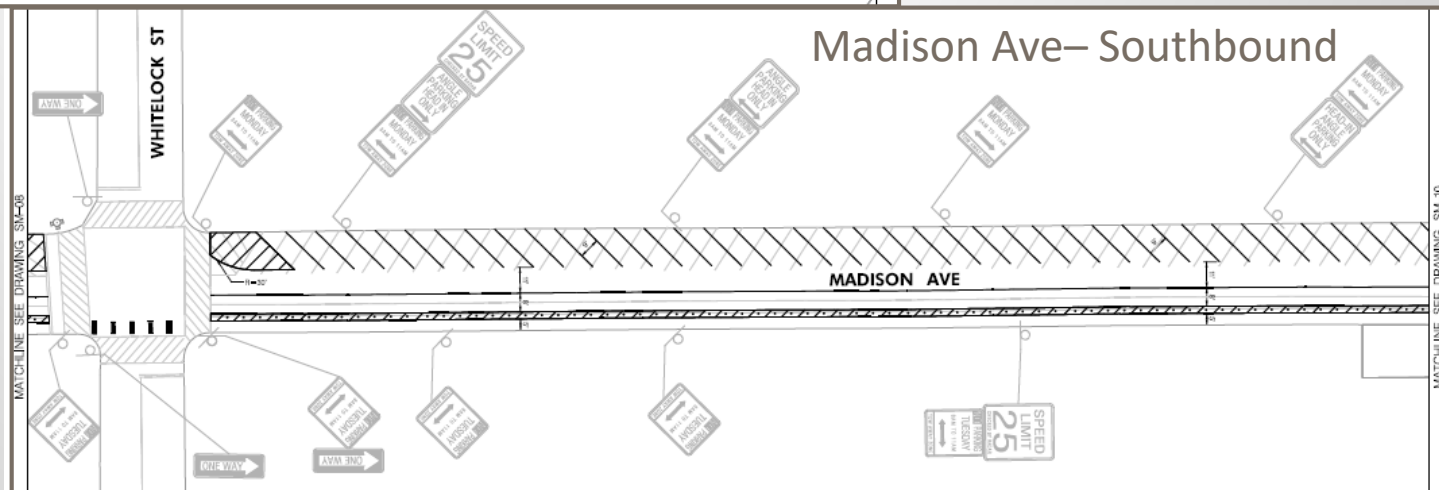
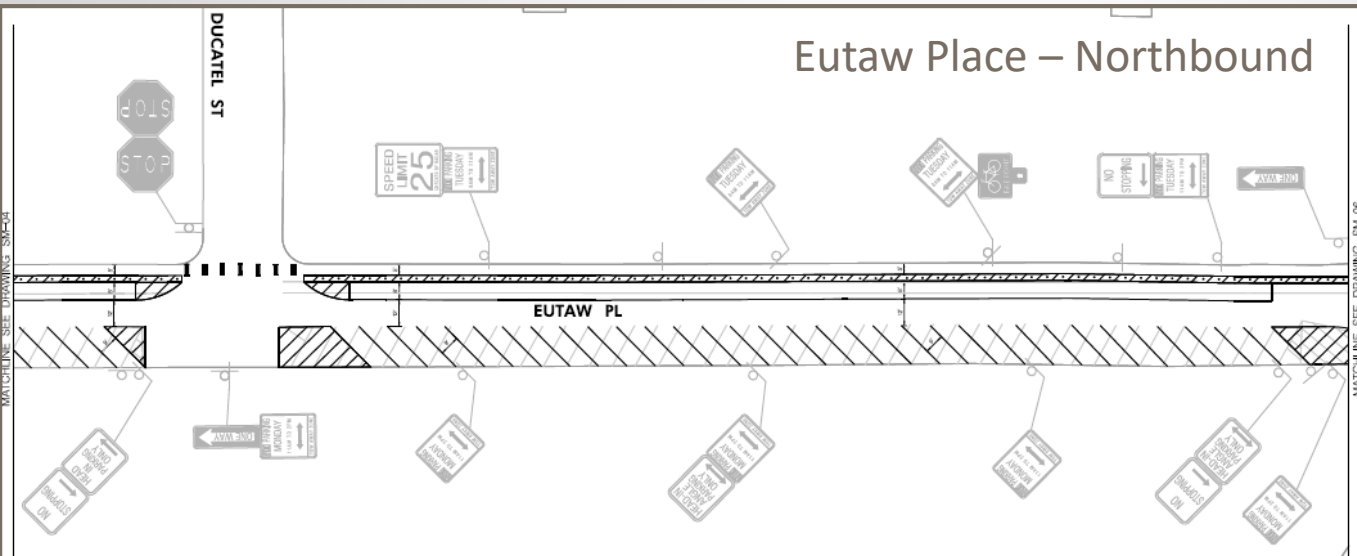

## St. Lo - Design

### Project Overview:

- Separated Bike Lane on St. Lo Drive: From Harford Road to Sinclair Lane
- Two-way separated bike lane on south side
- Traffic calming includes speed humps, road narrowing
- Pedestrian safety improvements, include: crosswalk treatments; shorter crossing distances; ADA ramps; and sidewalk improvements

### Design Example: St. Lo at Indian Head Dr.

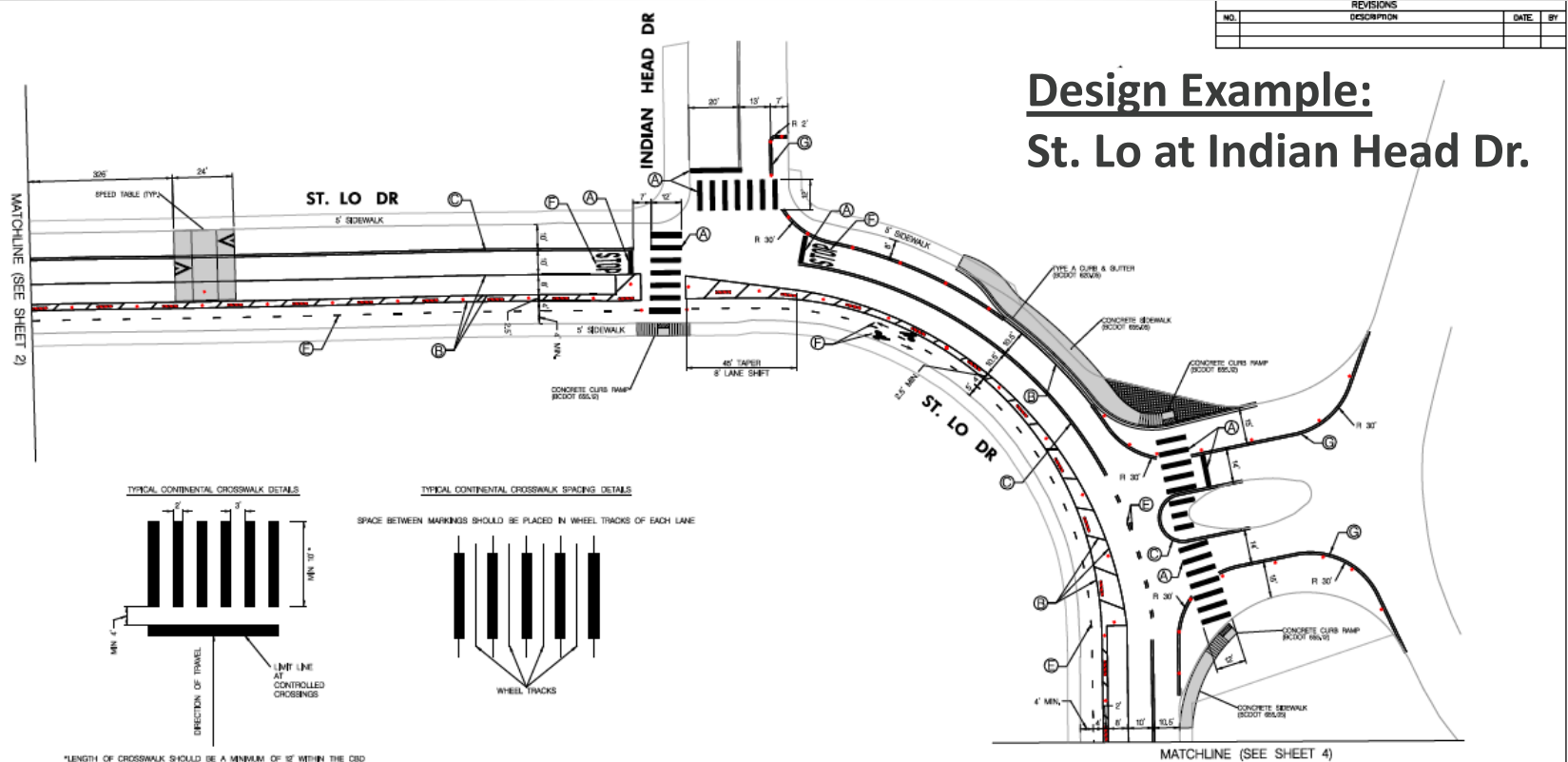

# University Parkway- Design

## Project Overview:

- Separated Bike Lane on University Pkwy: From San Martin Dr. to Charles St.
- One-way separated “parking protected” bike lane on both sides of street
- Pedestrian safety improvements, include: crosswalk treatments; curb bumpouts and shorter crossing distances; traffic calming.

## Design Example: U. Pkwy at Canterbury Rd.

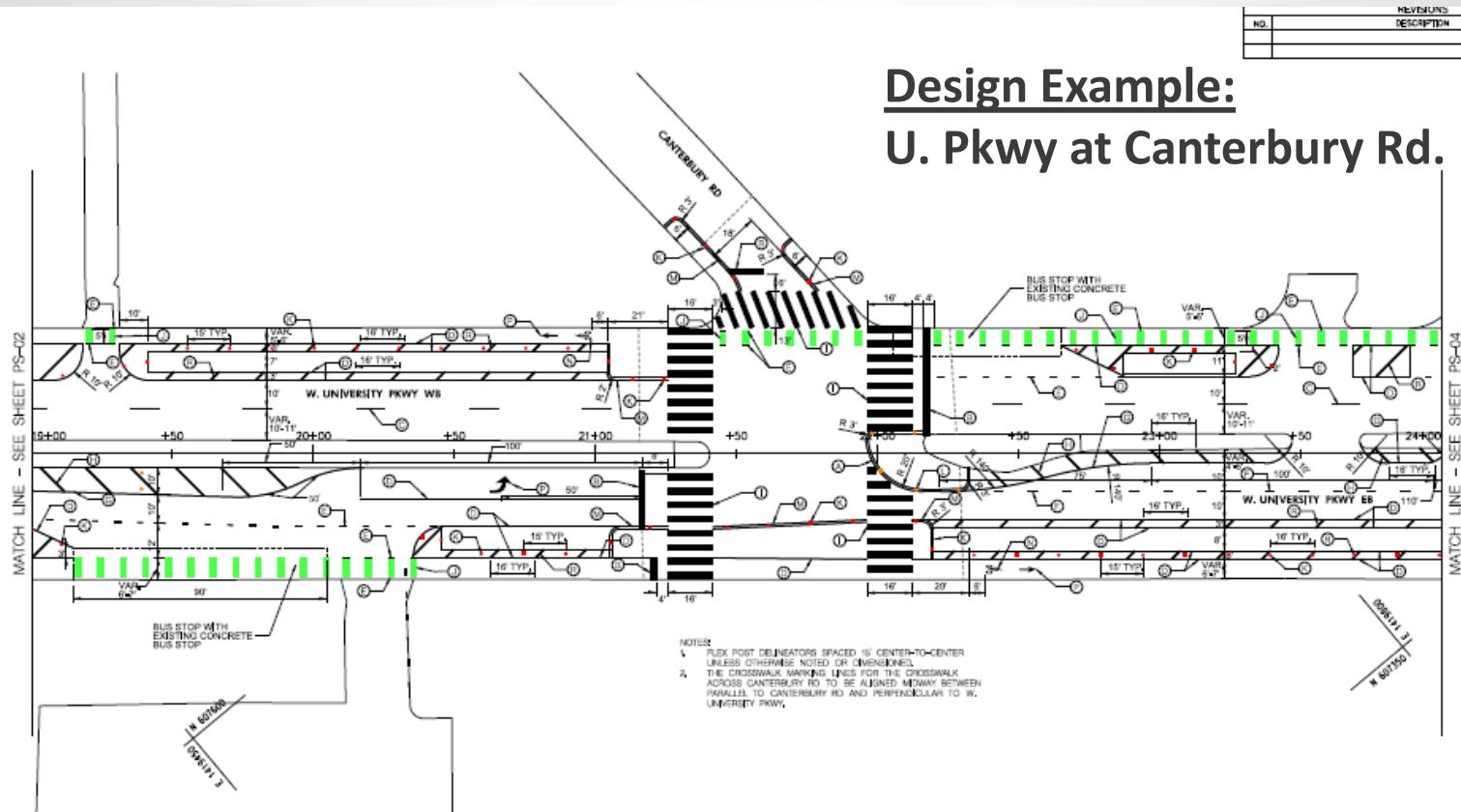



## Updates: DOT Bike Projects

| Task  | Partners                        | Notes  |
|---|---------------------------------|--|
| Eutaw Place Concept Development               | Study led by McCormick Taylor   | Scheduling Summer meeting with final design plans.   |
| Wolfe/Washington Existing Conditions Analysis | Study led by RKK                | Scheduling phase 3 of 4 in Summer.   |
| Bush Street Concept Development               | Study led by Toole Design Group | Coordinating with Toole next phase of outreach after 65% design.   |
| Bush Street Survey                            |                                 |  |
| Melrose Avenue Construction                   | DOT Internal                    | Bikeways complete. Scheduling installation of signal at Charles Street.                                  |
| Greenway Trail Network – Northern Segments    | Study led by RKK                | Held three public meetings in various neighborhoods 3/1-3. Follow up community meetings in Phase 2 of 4. |
| Big Jump Assessment Data Collection/Analysis  | Study led by Toole Design Group | <a href="#">Evaluation report released.</a>  |
| Big Jump Relocation                           |                                 | Coordinate DPW with construction schedule. Barrier procurement.  |
| Middle Branch                                 | DOT Internal; MDOT/SHA          | Successful project extension. Choose consultant and execute task.  |
| Rapid Enhancement Plan (REP)                  | DOT Internal                    | Beginning public meetings and stakeholder engagement and finalizing designs. Various stages.             |

## Miscellaneous Business

Next July meeting date is changed (because of scheduling conflicts) to August 3<sup>rd</sup> from 4-6pm

