

PLAN OF CASTING FRAME

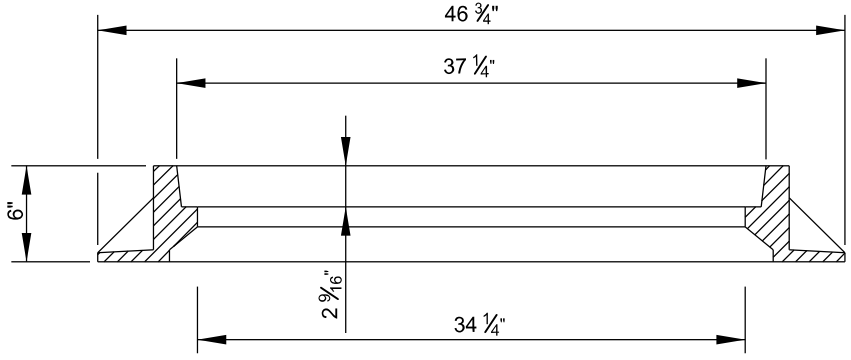

SECTION A-A

- NOTES:
1. MANHOLE COVER TO BE TRAFFIC RATED AASHTO M306.
  2. MANHOLE SHALL BE GRAY IRON ASTM A48 - CLASS 30B MIN.
  3. PROVIDE CHUCKING AREA AND HANDLING HOLES AS PER THE MANUFACTURERS DETAIL.
  4. PROVIDE 37 1/4" DIAMETER FOR FRAMES PAIRED WITH STANDARD 37" DOT CONDUIT MANHOLE COVER, BC 825.14-01.



APPROVED :

*Ola Olamide*  
CHIEF, CONDUIT DIVISION

*Husein Ra'za*  
DIRECTOR, DEPARTMENT OF TRANSPORTATION

CITY OF BALTIMORE  
DEPARTMENT OF TRANSPORTATION  
CONDUIT DIVISION

**MANHOLE - CONDUIT  
STANDARD 37" FRAME**

ISSUED	REVISED	REVISED
08/2024		

STANDARD NO.  
BC 825.14-02

SCALE : NONE      SHEET 1 OF 1