

NOTE: PLACE VERTICAL JOINT AT CENTER OF EVERY RAIL PANEL. JOINTS SHALL BE FORMED BY POURING ALTERNATE SECTIONS. THE POUR OF ADJACENT SECTIONS SHALL HAVE A TWO (2) DAY DELAY BETWEEN POURS. IN ORDER TO FORM A WATER TIGHT JOINT, A PARAFFIN COATING SHALL BE APPLIED AT EVERY JOINT. NO REINFORCING STEEL SHALL PASS THROUGH JOINT. JOINT SPACING, TREATMENT, ETC. APPLIES TO MEDIAN BARRIER ALSO.

NOTE: ALL LONGITUDINAL BARS ARE #5 BARS SPACED AS SHOWN (PARAPET AND MEDIAN BARRIERS)

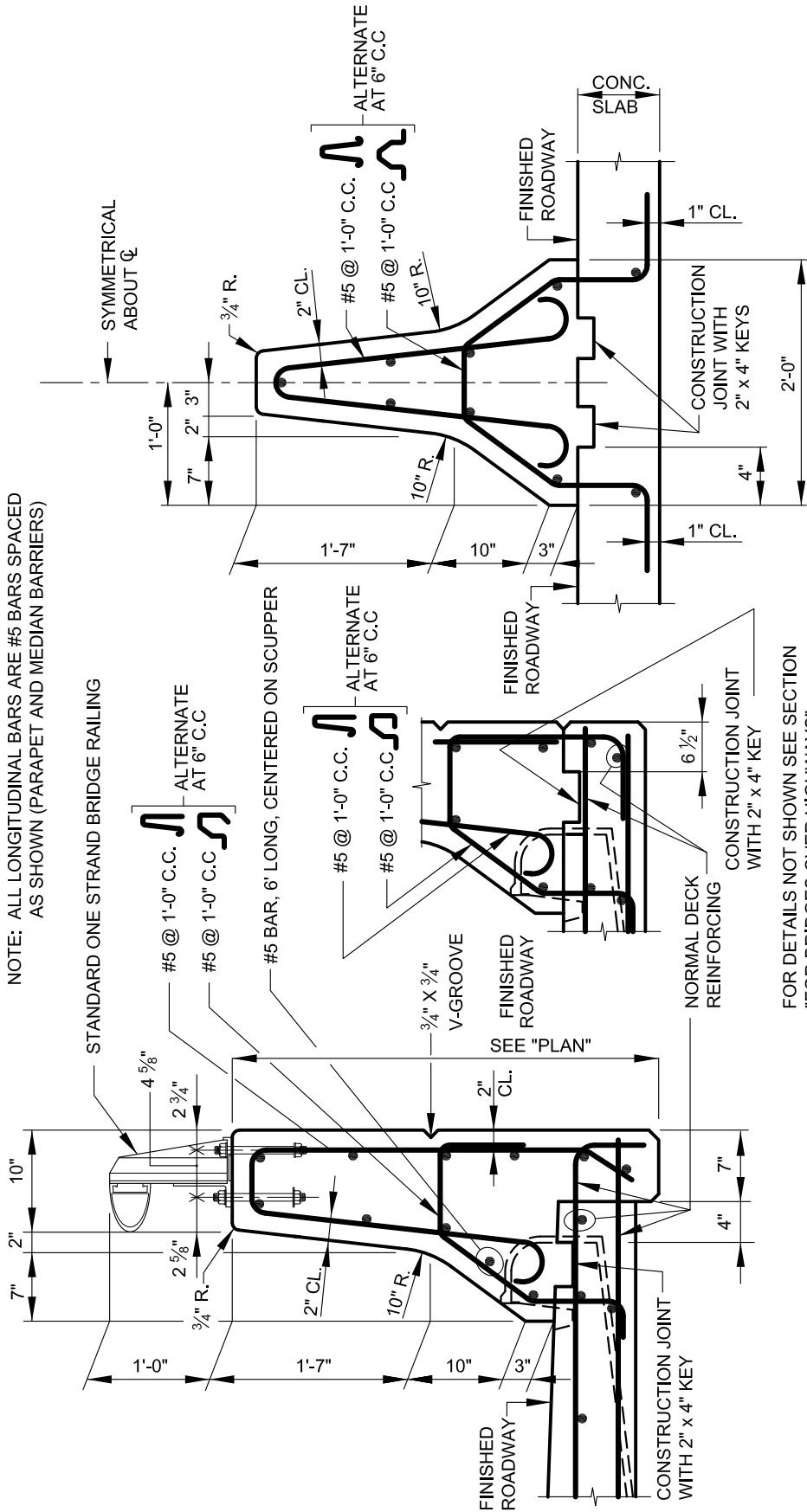

NORMAL DECK REINFORCING NOT SHOWN

FOR DETAILS NOT SHOWN SEE SECTION "FOR BRIDGES OVER HIGHWAYS"

NOTE: IF SCUPPERS ARE USED IN THIS BARRIER, EACH SCUPPER SHALL BE SET INTO BARRIER AS SHOWN. CHAMFER FROM BARRIER FACES OF CONCRETE TO FACE OF SCUPPER AS REQUIRED

FOR BRIDGES OVER HIGHWAY

FOR BRIDGES OVER STREAMS & RAILROAD

TYPICAL CROSS SECTIONS
BRIDGE MEDIAN BARRIER

TYPICAL CROSS SECTIONS - BRIDGE PARAPET



APPROVED:
Bimal DeWaha
DIVISION CHIEF, TRANSPORTATION ENGINEERING AND CONSTRUCTION
Khalil Zare
DIRECTOR, DEPARTMENT OF TRANSPORTATION

CITY OF BALTIMORE
DEPARTMENT OF TRANSPORTATION
TRANSPORTATION ENGINEERING AND CONSTRUCTION

**CONCRETE BARRIER
BRIDGE PARAPET
AND MEDIAN**

ISSUED	REVISED	REVISED
8 / 2010		
STANDARD NO. BC 470.01		
SCALE : NONE	SHEET 1 OF 1	