

INSTALL 1/2" EXTERIOR GRADE MARINE PLYWOOD  
BACKBOARD PAINTED GRAY

\* MEASURING FROM  
THE CABINET, NOT  
THE BACKBOARD

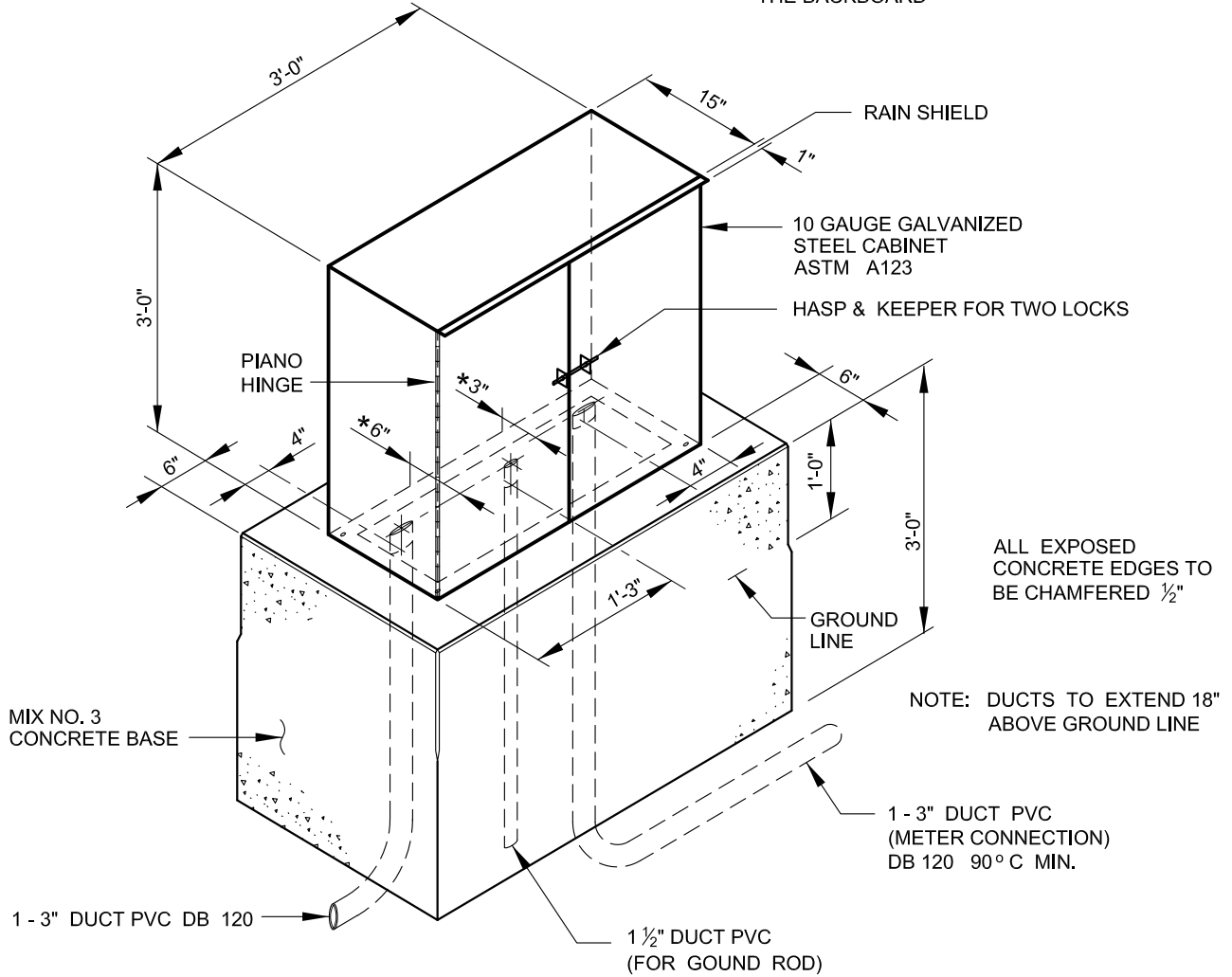

**N.E.M.A. 3R FREE STANDING METER CABINET**

NTS

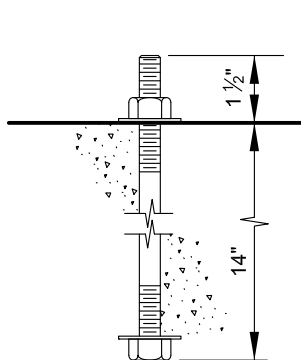

BOLT SIZE 1/2" STAINLESS STEEL

**ANCHOR BOLT DETAIL**

NTS

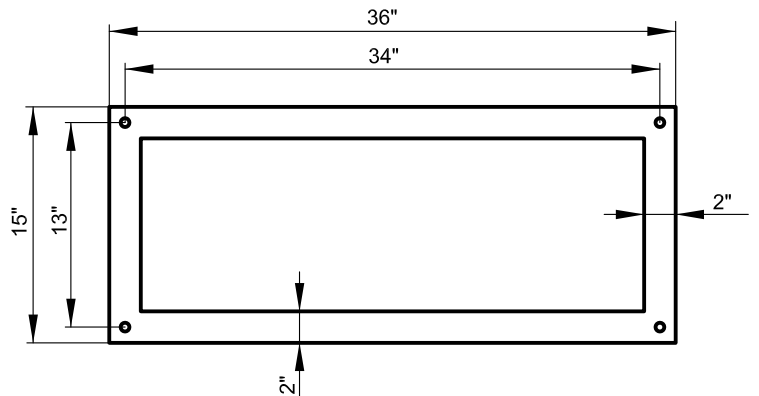

**CABINET BASE DETAIL**

NTS



APPROVED:

*Primal Dev...*  
DIVISION CHIEF, TRANSPORTATION ENGINEERING  
AND CONSTRUCTION  
*Khalil Z...*  
DIRECTOR, DEPARTMENT OF TRANSPORTATION

CITY OF BALTIMORE  
DEPARTMENT OF TRANSPORTATION  
TRANSPORTATION ENGINEERING AND  
CONSTRUCTION

**METER CABINET  
FOR ELECTRICAL SERVICE**

ISSUED	REVISED	REVISED
8 / 2010		
STANDARD NO. BC 804.10		
SCALE : NONE		SHEET 1 OF 1